

N=Number of contacts

P.C.B. LAYOUT

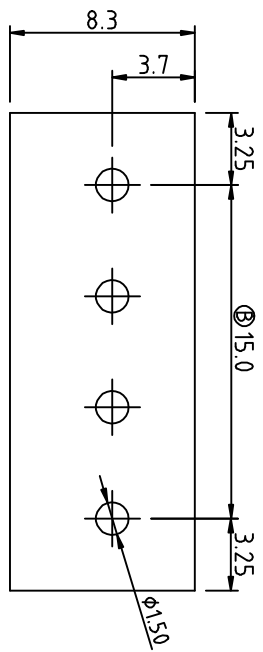

SIGN	DATE	DESCRIPTION	APPROVER
△	6.15	Engineering drawing No. is changed.	
△	10.2	Standard spec is changed.	
△	10.2	The dimension changed from 4.8 to 4.4.	

Technical Data:

Material:

- Contact(metal housing): Brass Stamping
- Terminal screw: Steel galvanized and chromitized or Nickel plated or Tin plated (standard) (option)
- Wire guard: Copper Alloy
- Surface of solder tail: Tin plated
- Insulator body(housing): Polyamide(Glass filled)(UL94V-0)

Electrical

- Voltage rating: 300VAC
- Current rating: 10Amps/way max
- Contact resistance: 20mΩ(max)
- Insulation resistance: 5000MΩ/1000V
- Withstanding Voltage: 1500VAC(1min) Test time=60sec/1pcs
- Wire range: 12-18AWG

Mechanical:

- Torque: 4kgf·cm/M2.5
- Operating temperature: -33°C to +120°C
- Soldering reliability: Test temperature= 250°C±10°C 5 seconds max

Safety approval data: 

POLE	4P	
A	NX5.0-15	21.5
B	(N-1) X5.0	15.0

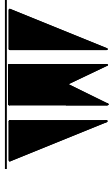

杰科电子有限公司
JIE KE ELECTRONICS CO., LTD.

PART NAME: JK166-500 4P

TITLE:

PART. NO.:

DWG NAME:

APPROVED BY

CHECKED BY

DESIGNED BY

DRAWN BY

CUSTOM NO.:

UNITS: mm
SCALE: 4/1
REVISION: B3

Tolerance
x: ±0.50
xx: ±0.30
xxx: ±0.10
xxx: ±1°

安杰

孙学峰

杨丽霞

杨丽霞

